



OriGen
BIOMEDICAL

ACCESSORY CATALOG

OriGen

BIOMEDICAL

Mission Statement:
We create medical products which improve peoples' lives.

Why Choose OriGen?

Quality Commitment

Product quality is the foundation of all product design at OriGen, and each product is produced with the intention to improve patient health. OriGen is certified to ISO13485 and MDSAP standards, and is regularly inspected by the FDA, ISO-certification organizations, and our customers. We maintain worldwide certifications to cGMPs and our products are registered with regulatory agencies across the world.

Customer Commitment

We offer superior products and excellent customer service. We listen to our customers and work with them to develop products that meet their needs. OriGen is not just another supplier; we are a partner committed to providing our customers with solutions tailored to their specific needs. As an OriGen customer, you can be sure that the same attention to detail has gone into every product with the OriGen label.

User Inspired Design Commitment

OriGen strives to provide products that make cell culture and cryopreservation processes intuitive, safe, and efficient. OriGen engineers work closely with our customers to develop products that fit current lab practices so that customers do not have to adapt their processes to fit our products.



As part of our commitment to provide user-inspired products, cell processing professionals can work with OriGen to develop a unique solution through our customer-driven product development process. Please visit our website or contact your Account Manager to learn more about OriGen's capabilities and the product development process.

Please note:

- This catalog contains both stock and non-stock products.
- The symbol (*) appears throughout the catalog and indicates the fluid path of the product can be exposed to 100% DMSO solution for at least 24 hours without showing signs of degradation or visible product changes.
- Drawings are not to scale and tubing lengths may be shortened to better highlight component detail.

Sterile Access & Spike Adapters

Product Code	Description	Stock/ Non-Stock	Case Qty
NFV*	Needle-free valve with caps	Stock	10
PC2-B	Protective cap for female luer	Non-Stock	50

Product Code	Description	Stock/ Non-Stock	Case Qty
CT	Cryotape. Cryogenic tape that is stable in LN vapor phase 1¼" X 8" strips	Stock	10

Product Code	Description	Stock/ Non-Stock	Case Qty
SC-1*	A 4-way stopcock that regulates the flow of fluid through a tube	Stock	50

Product Code	Description	Stock/ Non-Stock	Case Qty
CBS*	One spike with needle-free valve	Stock	50
IBS	One spike with needle injection site	Stock	50

Product Code	Description	Stock/ Non-Stock	Case Qty
VSV*	Vial spike with needle-free valve	Stock	10

PC2-B

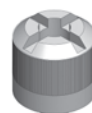

NFV

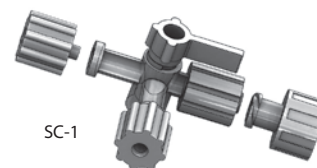

SC-1



CBS

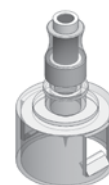

VSV

* indicates 100% DMSO resistance

Spike Adapters and Manifold Sets

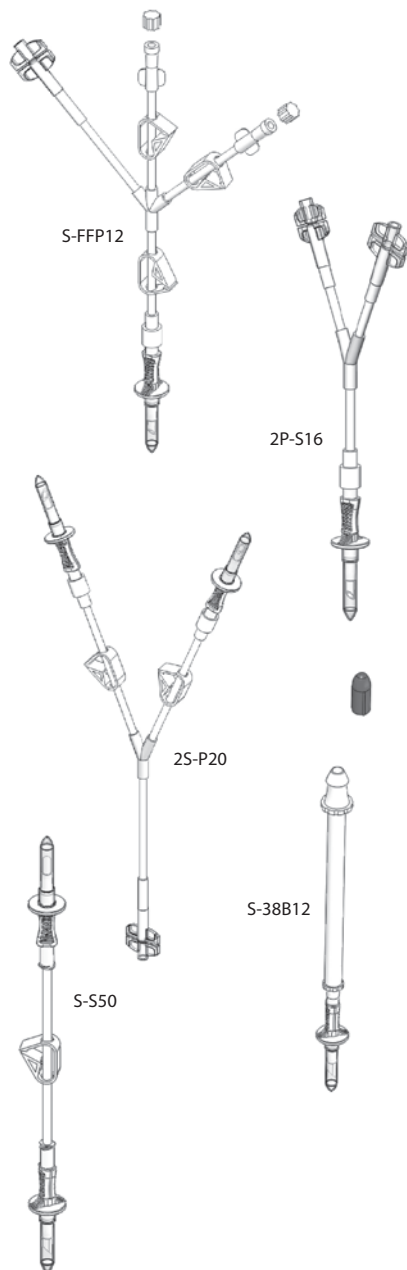

Product Code	Description	Stock/ Non-Stock	Case Qty
S-FFP12	One spike to one spike port and two female luers with 12cm SCD tubing and pinch clamps	Stock	20

Product Code	Description	Stock/ Non-Stock	Case Qty
2P-S16	Two spike ports to one spike with 16cm SCD tubing	Non-Stock	20

Product Code	Description	Stock/ Non-Stock	Case Qty
2S-P20	Two spikes to one spike port with 20cm SCD tubing and pinch clamps	Stock	20

Product Code	Description	Stock/ Non-Stock	Case Qty
S-38B12*	One spike to one 3/8" barb with 12cm tubing	Stock	25

Product Code	Description	Stock/ Non-Stock	Case Qty
S-550	One spike to one spike with 50cm of SCD tubing and pinch clamp	Non-Stock	50

Spike Adapters and Manifold Sets

Product Code	Description	Stock/ Non-Stock	Case Qty
S-F10*	One spike to one female luer with 10cm of tubing and pinch clamp	Stock	50
S-F50	One spike to one female luer with 50cm of SCD tubing and pinch clamp	Stock	50

Product Code	Description	Stock/ Non-Stock	Case Qty
S-M50	One spike to one male luer with 50cm SCD tubing and pinch clamp	Stock	50

Product Code	Description	Stock/ Non-Stock	Case Qty
4S-4M60	Four spikes to four male luers with 60cm SCD tubing, roller and pinch clamps	Stock	12

Product Code	Description	Stock/ Non-Stock	Case Qty
F-8S100	One female luer to eight spikes with 100cm SCD tubing and pinch clamps	Non-Stock	12

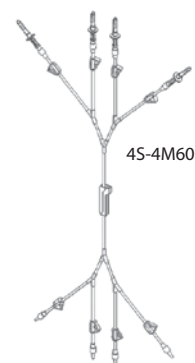

* indicates 100% DMSO resistance

Syringes

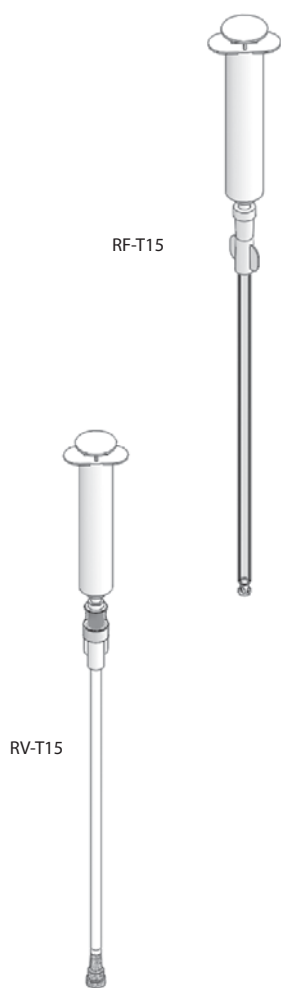

Product Code	Description	Stock/ Non-Stock	Case Qty
15-R3FT	3ml syringe on a female luer with 15cm of SCD tubing	Non-Stock	25
R3F-T15	3ml syringe on a female luer with 15cm sealed SCD tubing	Stock	25
RF-T15	6ml syringe on a female luer with 15cm sealed SCD tubing	Stock	25
15-RF12-T	12ml syringe on a female luer with 15cm sealed SCD tubing	Stock	25
15-RF20-T	20ml syringe on a female luer with 15cm sealed SCD tubing	Stock	25
15-RF60-T	60ml syringe on a female luer with 15cm sealed SCD tubing	Stock	25
RV-T15	6ml syringe on a needle-free valve with 15cm SCD tubing (tubing is plugged with a breathable vent)	Non-Stock	25
RV50-T15	60ml syringe on a needle free valve with 15cm SCD tubing (tubing is plugged with a breathable vent)	Non-Stock	20

Cell Connect™

Product Code	Description	Stock/ Non-Stock	Case Qty
CC1	Two spikes to a 3-way stopcock, 60ml syringe and needle-free valve to four male luer with SCD tubing and pinch clamps	Stock	12
CC2	One spike and one male luer to a 3-way stopcock, 60ml syringe and needle-free valve to four male luers with SCD tubing and pinch clamps	Stock	12
45-F-9M	One female luer to nine male luers with 45cm SCD tubing and pinch clamps	Non-Stock	10

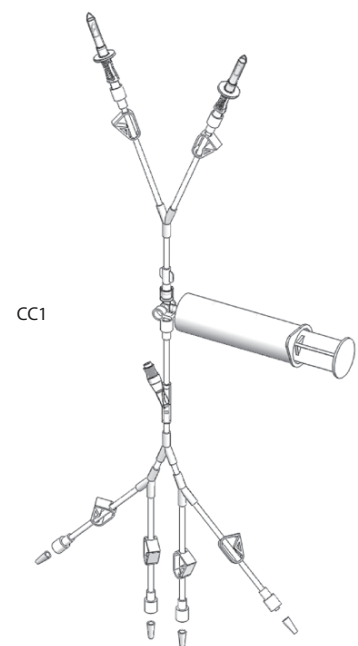

Cell Connect™

Example of use:

Close all pinch clamps. Attach cells to spike (A) and attached freeze media to spike (B). Attach up to four CryoStore™ freezing bags via male luers (E). Seal off any unused tubes to reduce cell loss. Open pinch clamps to the desired pathway, transfer cells and solutions. A rocker or oscillator is recommended for freeze media addition.

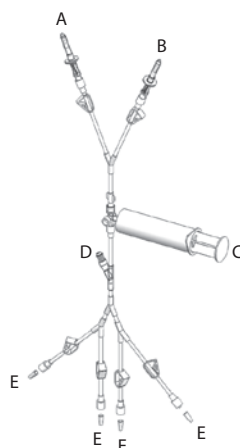

* indicates 100% DMSO resistance

Tube Adapters

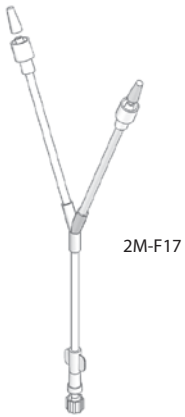

Product Code	Description	Stock/ Non-Stock	Case Qty
2M-F17*	Two male luers to one female luer with 17cm of tubing	Non-Stock	20
24-T-3T	Three 12cm SCD tube leads to one 12cm SCD tube lead	Non-Stock	20

Notes:



OriGen

BIOMEDICAL

7000 Burleson Rd, Bldg D
Austin, TX USA 78744-3202
Tel: +1 (512) 474 7278
Tel: Toll Free (800) 233 9014
E-mail: sales.us@origen.com

ML04.02.R03
2019 Issue



www.origen.com

